

# Timber construction initiative of Baden-Württemberg

Jan Bulmer | Oulu | 12



Baden-Württemberg

MINISTERIUM FÜR LÄNDLICHEN RAUM UND VERBRAUCHERSCHUTZ



Baden-Württemberg



## Motivation, Reasons & Targets

Why a timber construction initiative?

# Motivation

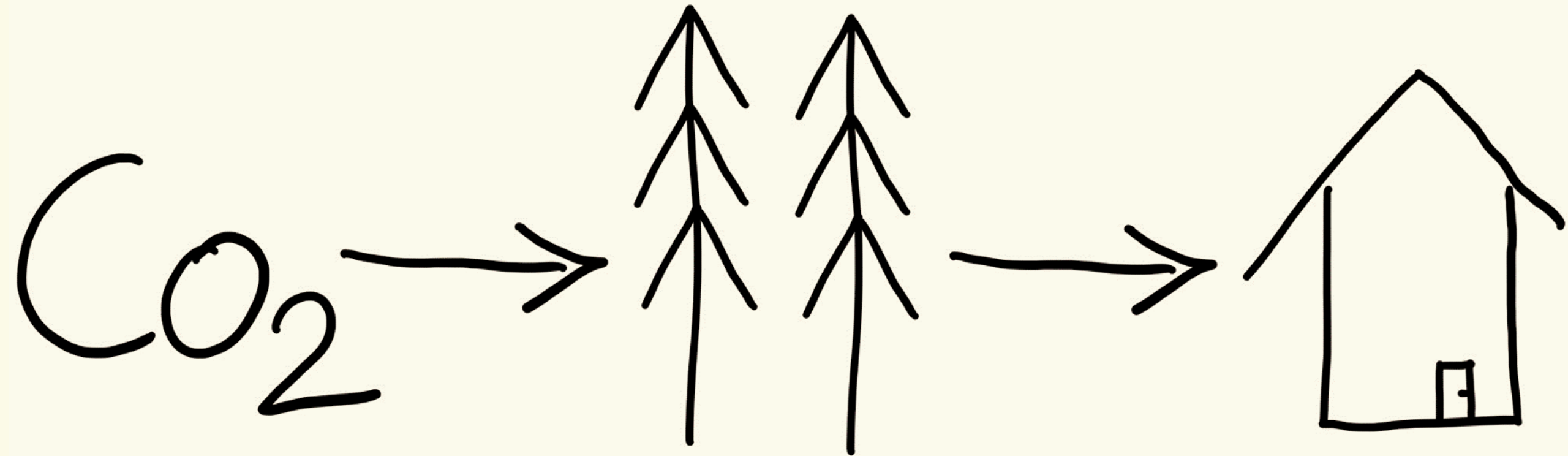

# Reasons

Sustainability Decarbonisation CO<sub>2</sub> Storage BioEconomy  
Rental Fees Greta Infrastructure Building culture Trends  
etter Ressource Restructured Forests Urbanisation Red  
ensification Responsibility Fridays For Future Rural Area  
s Digitisation Innovation Climate



# Targets

We want to make Baden-Wuerttemberg more liveable by wooden buildings!

By providing high-quality and sustainable Spaces,  
by supporting rural businesses,  
and by establishing BW as trendsetter for a climate aware building culture.



Baden-Württemberg

MINISTERIUM FÜR LÄNDLICHEN RAUM UND VERBRAUCHERSCHUTZ



Baden-Württemberg



Coordination

Behind the scene...

# Coordination

- Project term of 4 years
- Budget of around 25 mio. €
- Leadership at the ministry of rural affairs and consumer protection
- 13 innovation fields



# Coordination

**Jan Bulmer** & Tim Siemens

- Since 14.06.19 at the Ministry as Coordinator
- Experience :
  - till then Clustermanager at proHolzBW
  - before Clustermanager at proHolz Schwarzwald
  - apprenticed Carpenter, Bachelor of forest management and Master of timber products and management



Baden-Württemberg

MINISTERIUM FÜR LÄNDLICHEN RAUM UND VERBRAUCHERSCHUTZ





# Coordination

Jan Bulmer & **Tim Siemens**

- Since 14.06.19 at the Ministry as Coordinator
- Experience:
  - till then project supervisor for infrastructure projects at DB Engineering & Consulting
  - M. Sc. Resource Efficient Building (HS Rottenburg)
  - B. Eng. Civil Engineering (DHBW Mosbach)



Baden-Württemberg

MINISTERIUM FÜR LÄNDLICHEN RAUM UND VERBRAUCHERSCHUTZ



Baden-Württemberg



Involved Ministries

The governmental consortium

# Involved Ministries

Ministry of the Interior,  
Digitisation and  
Migration

Ministry of Science,  
Research and the Arts

Ministry of Finance

Ministry of the  
Environment, Climate  
Protection and the  
Energy Sector

State Ministry

## **Timber construction initiative**

of Baden-Wuerttemberg

Ministry of Economic  
Affairs, Labour and  
Housing

Ministry of Rural Affairs and Consumer Protection  
(Leadership)



Baden-Württemberg

MINISTERIUM FÜR LÄNDLICHEN RAUM UND VERBRAUCHERSCHUTZ

# Selection of current projects

- Implementation of several timber construction professorships
- Building culture handbook for BW
- Scientific monitoring of governmental timber construction prototypes
- Governmental funding for digitisation projects in timber construction
- Education events and expert panels for knowledge transfer

## **(29. January 2020 Architecture Forum in Stuttgart)**

- Online platform and communication
- Internationalisation with Japan, Austria and Finland
- Financial support of innovative prototype





Baden-Württemberg

 Wood's Up

Developments and Chances

# Good Arguments for wooden buildings



Baden-Württemberg

MINISTERIUM FÜR LÄNDLICHEN RAUM UND VERBRAUCHERSCHUTZ



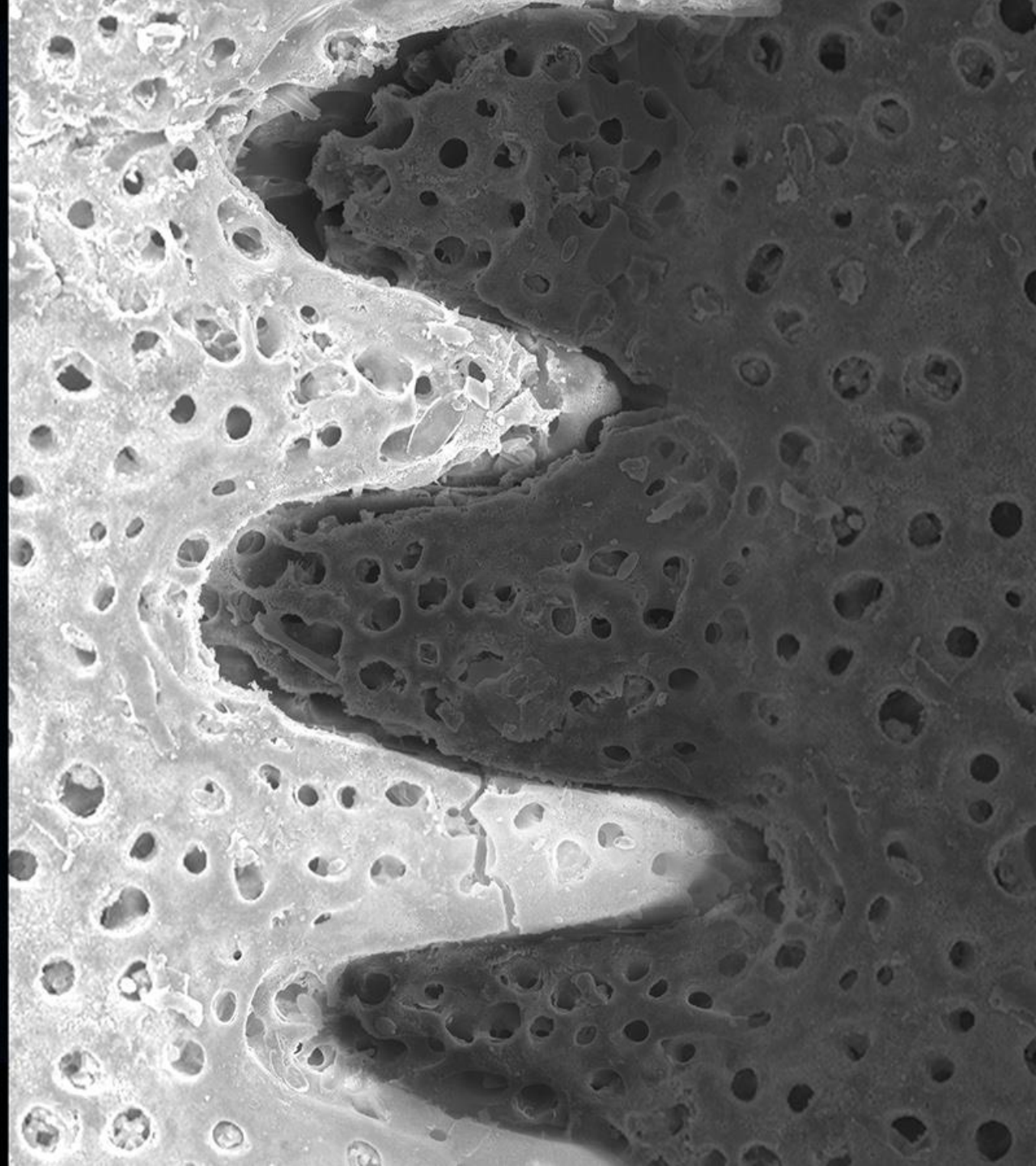
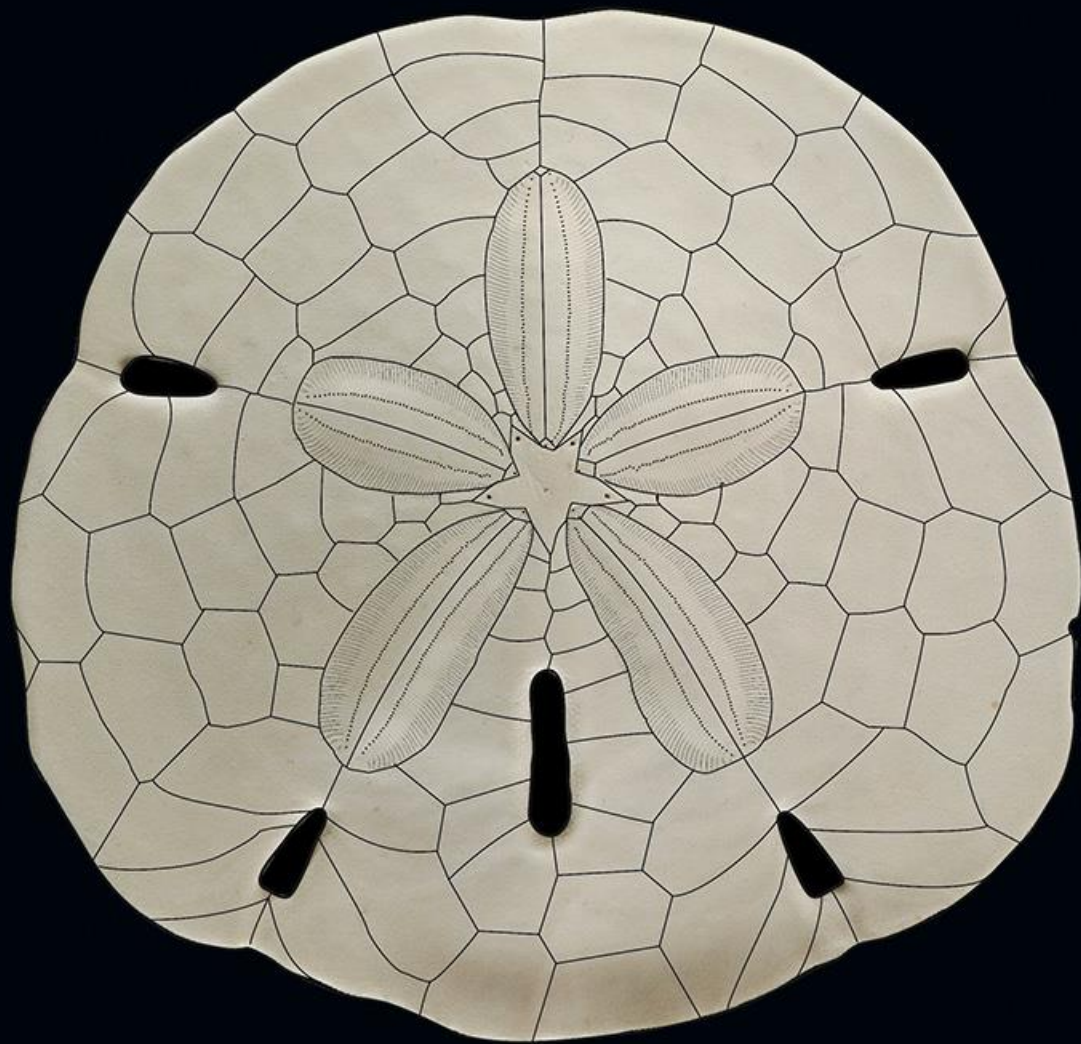

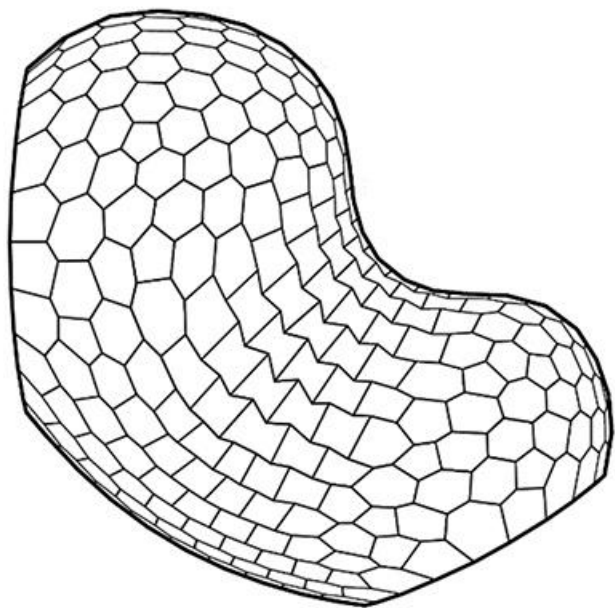

LAGA Pavilion

36.8 kg/m<sup>2</sup>

11m Span

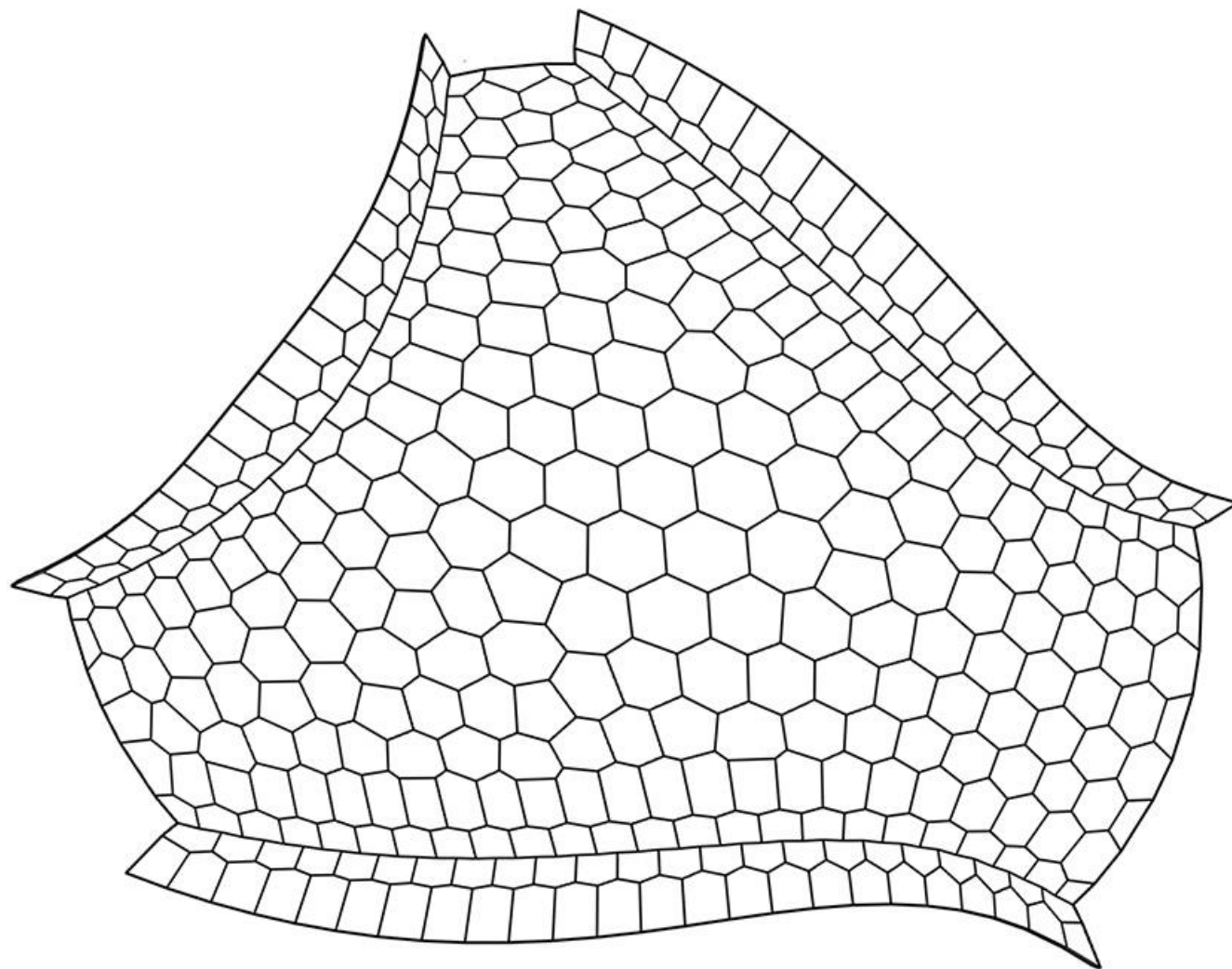

BUGA Pavilion

36.0 kg/m<sup>2</sup>

30m Span

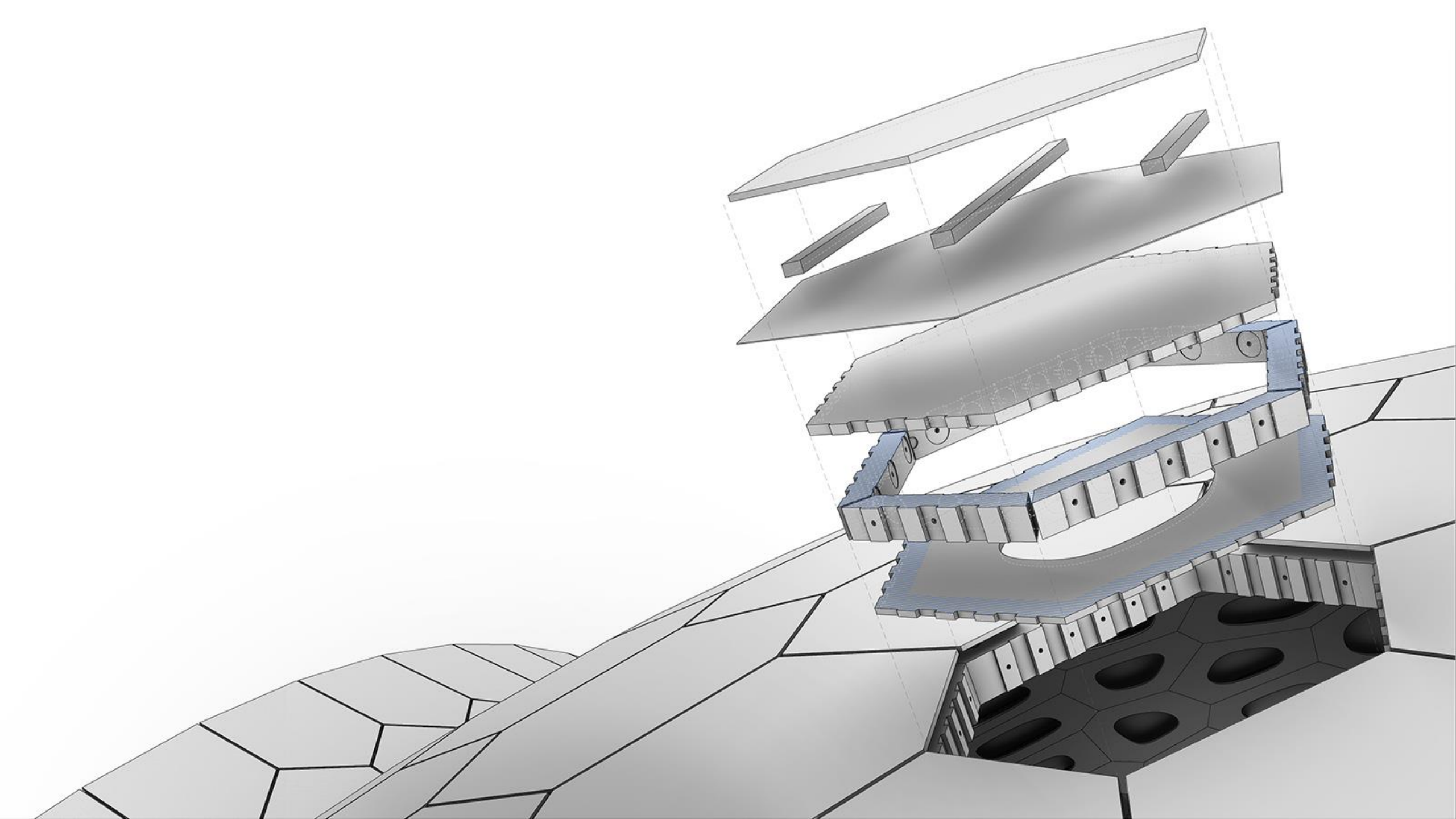

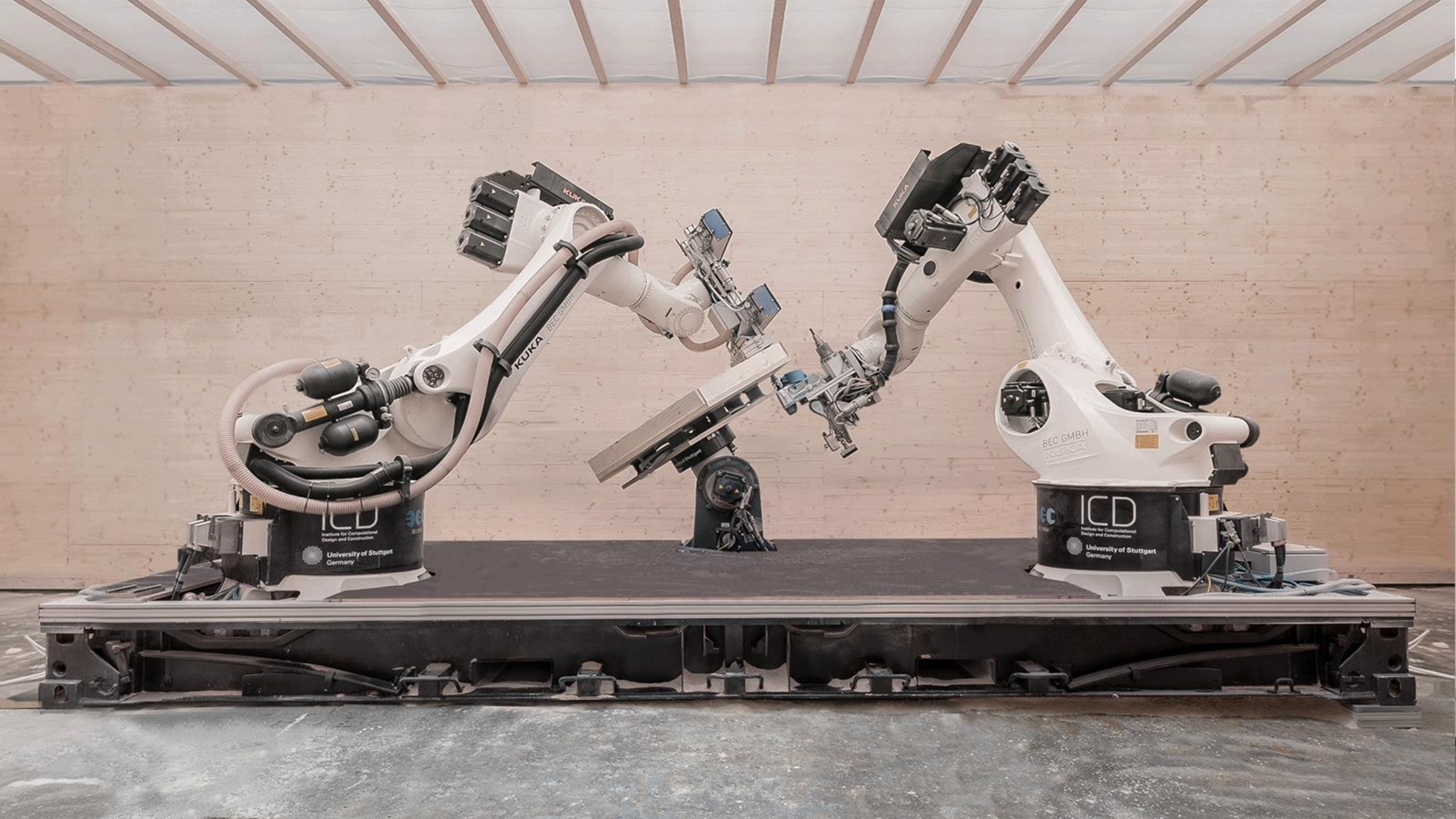

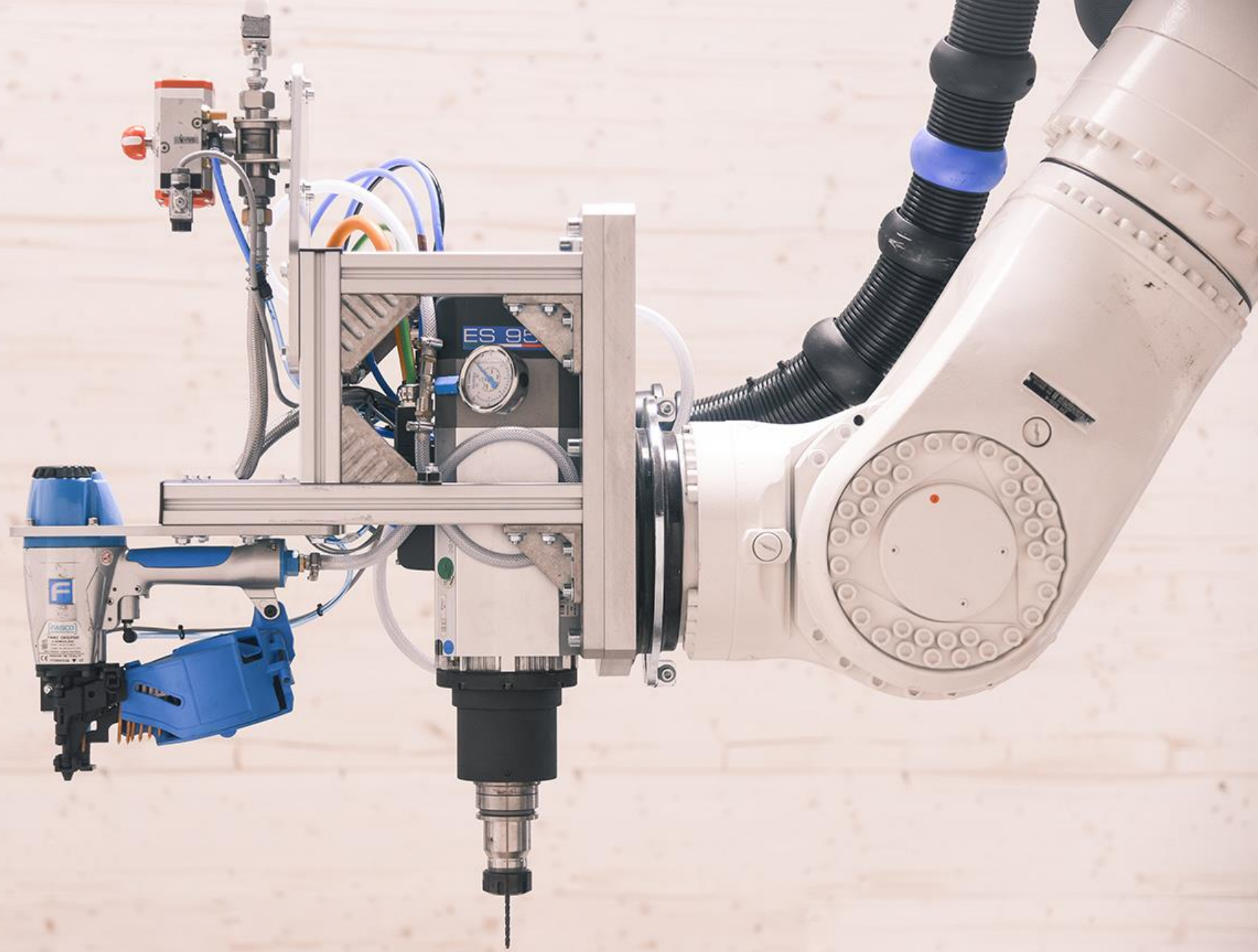





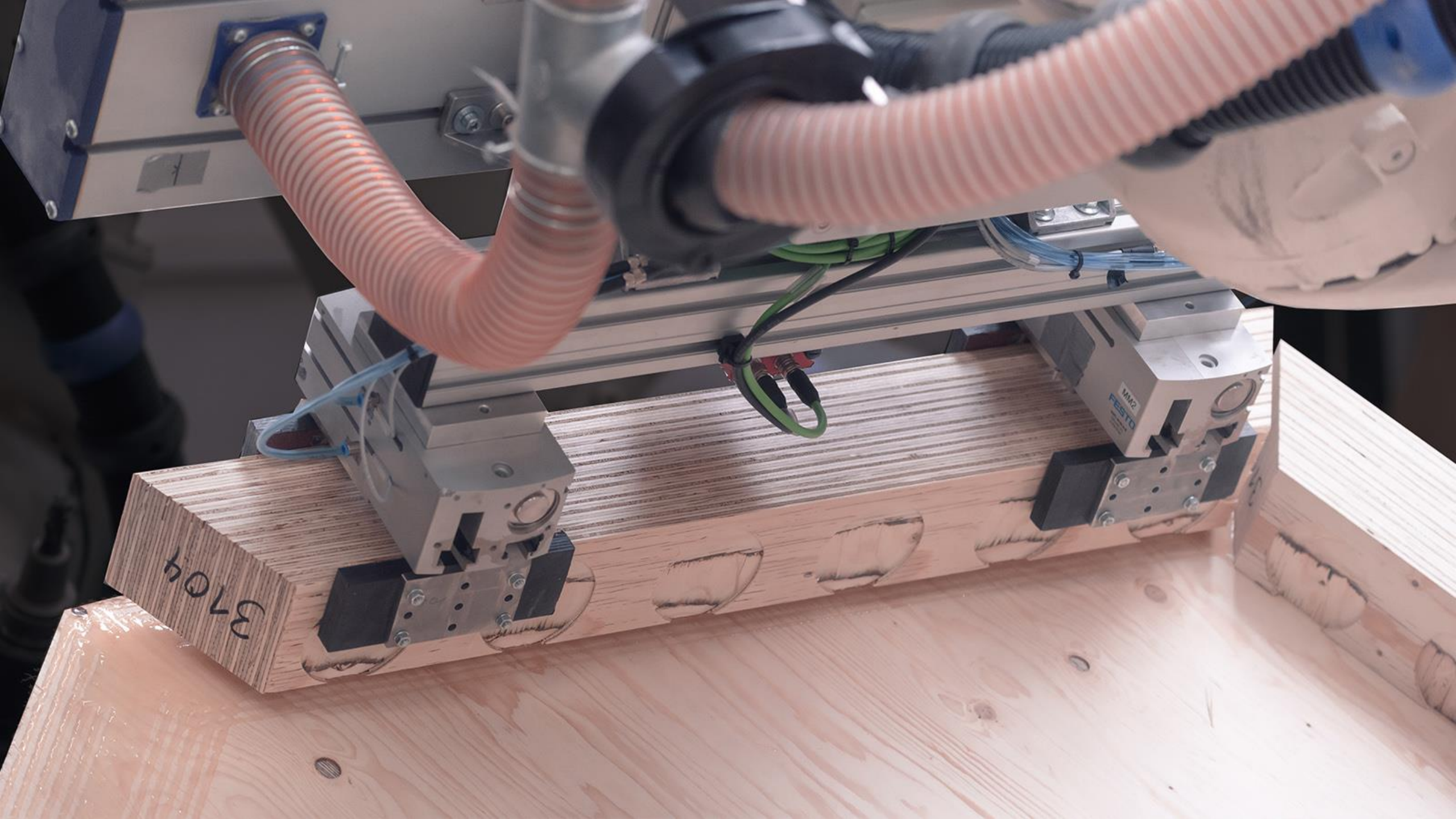



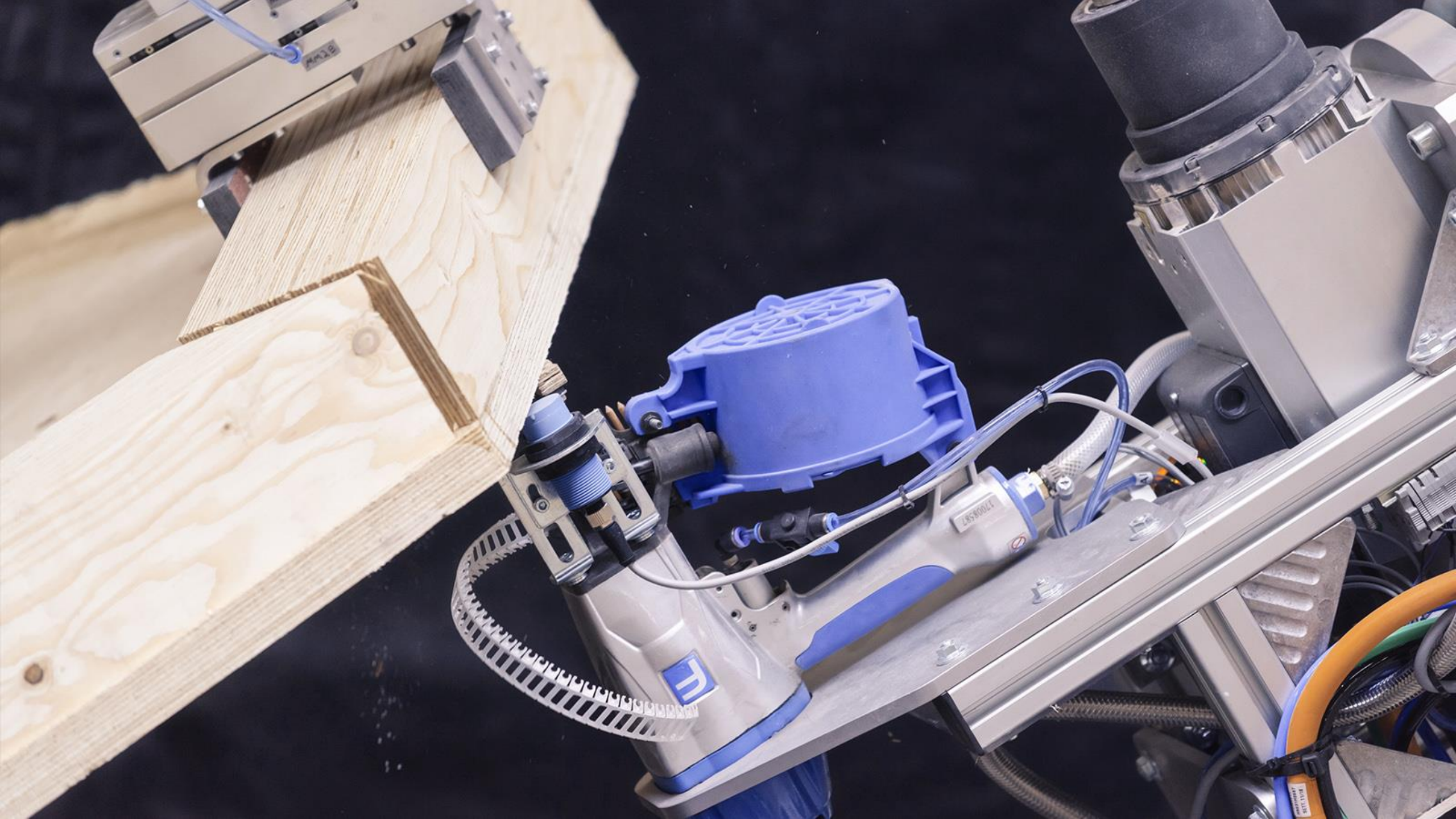

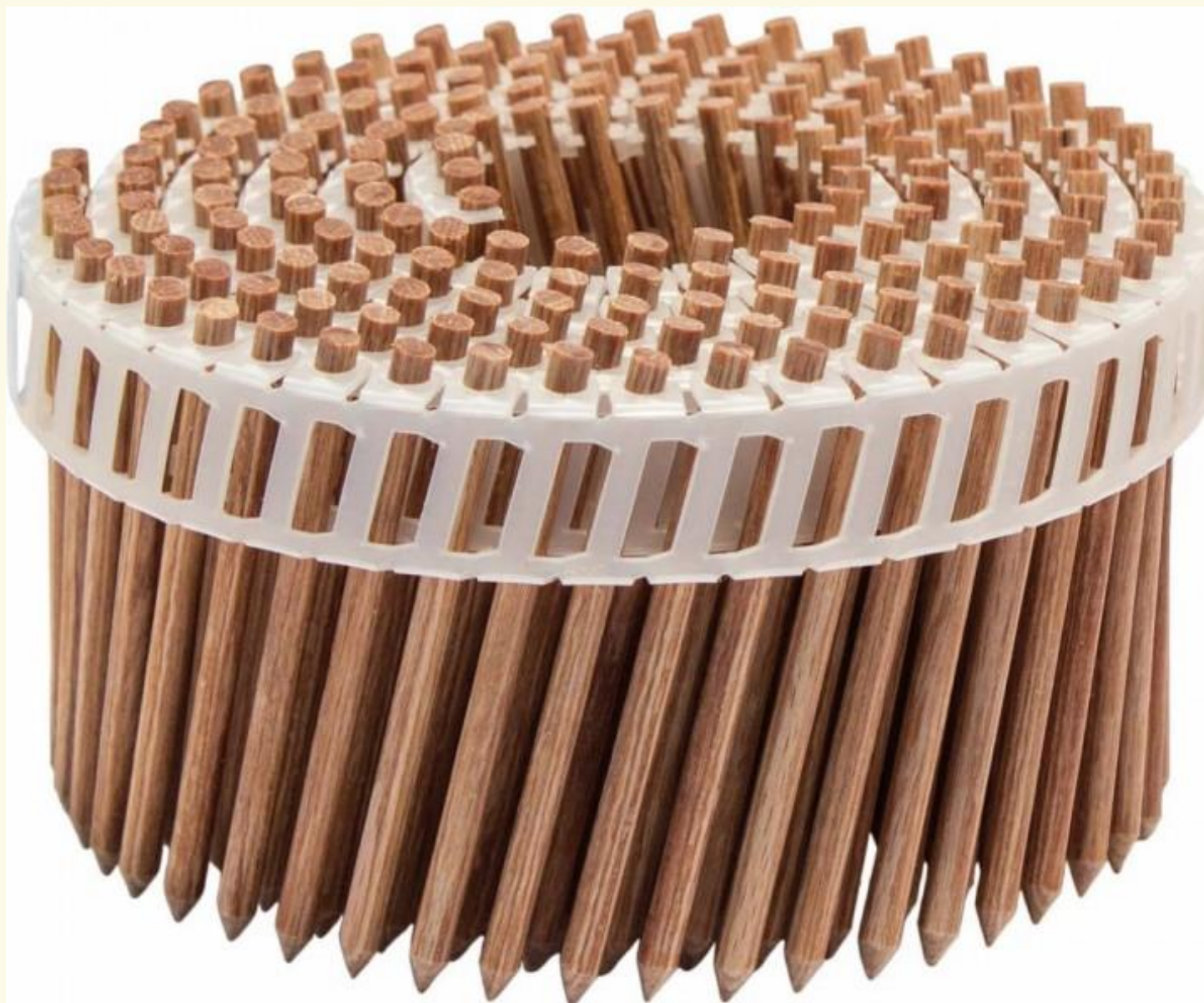

Baden-Württemberg

MINISTERIUM FÜR LÄNDLICHEN RAUM UND VERBRAUCHERSCHUTZ

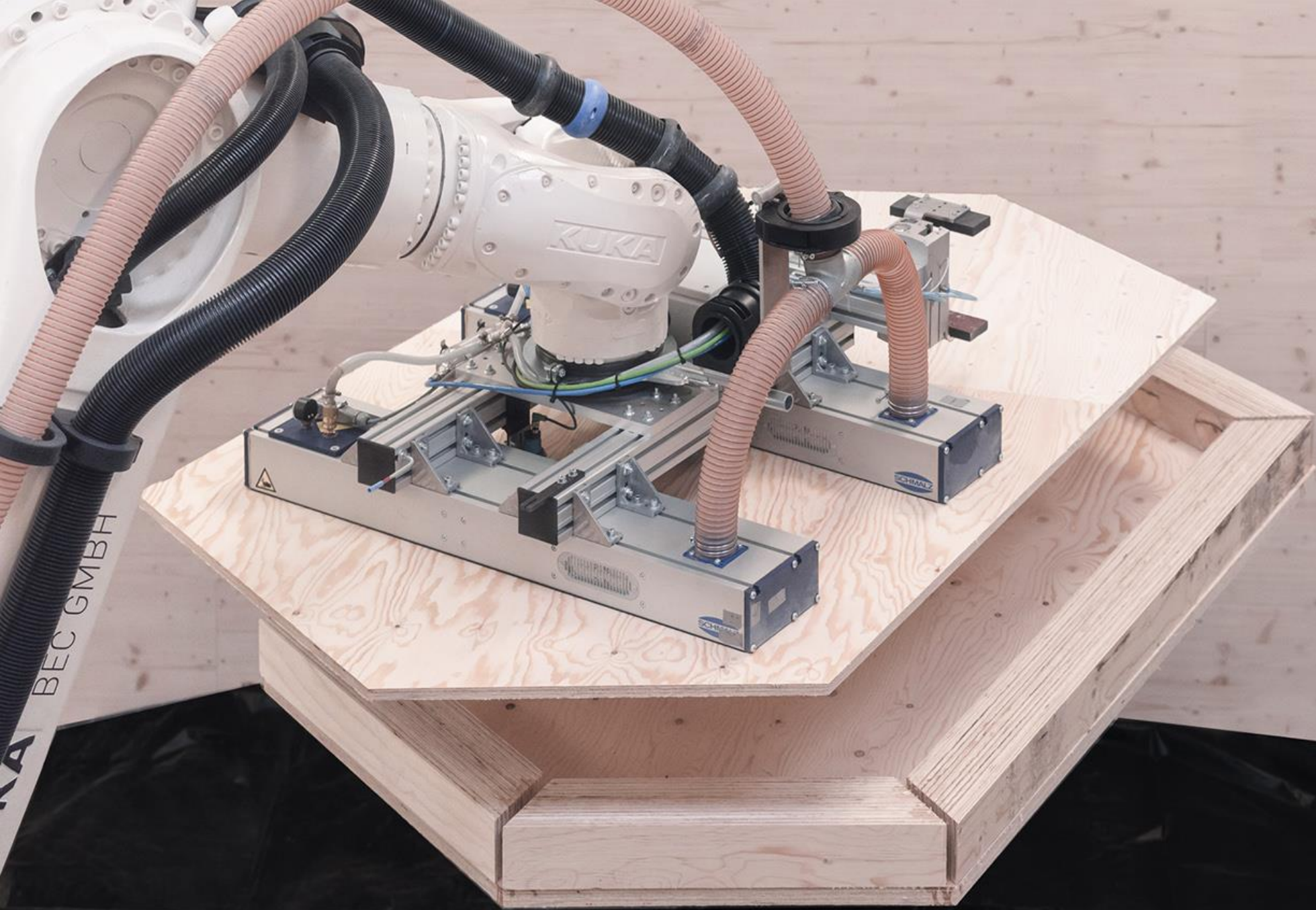

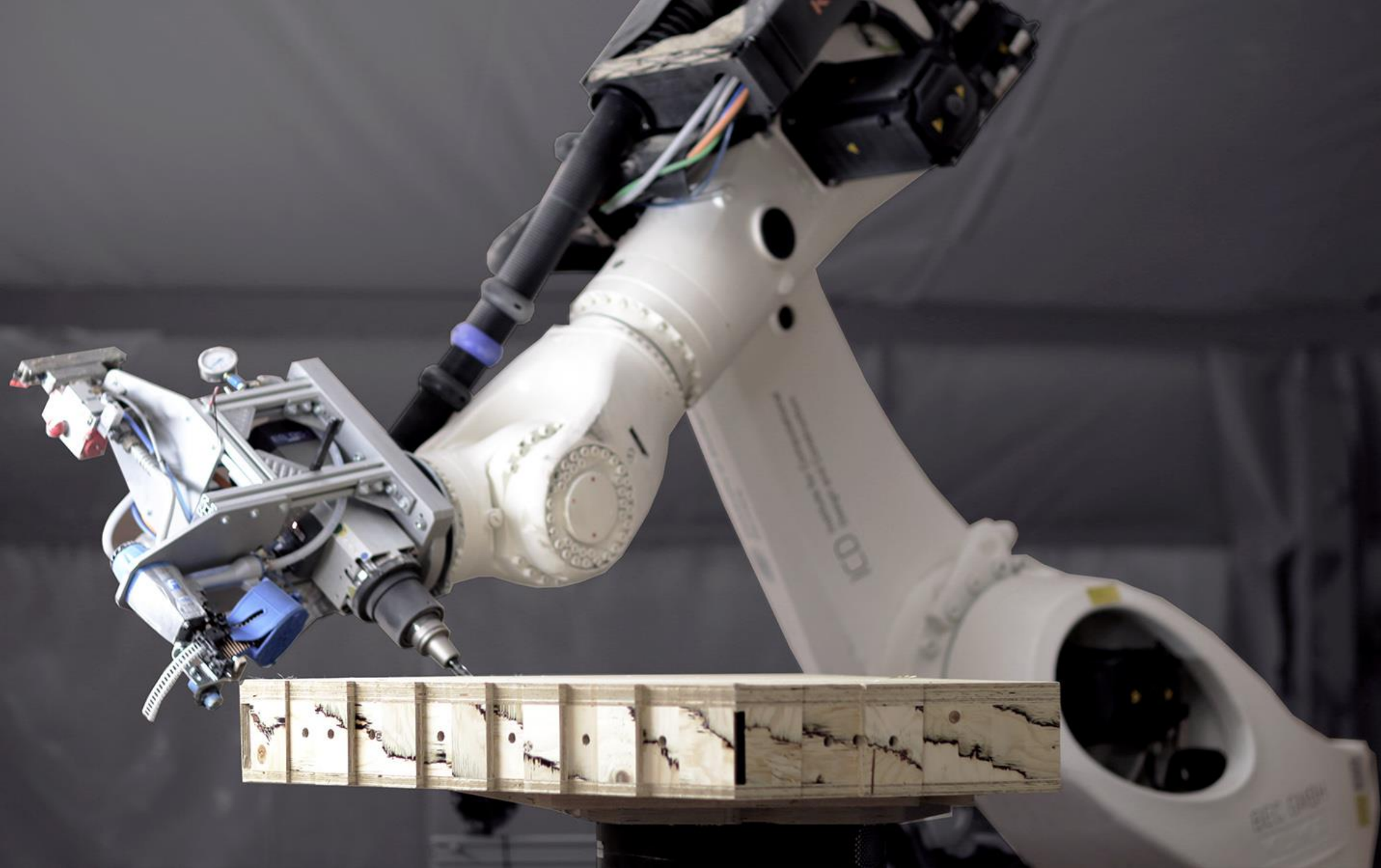













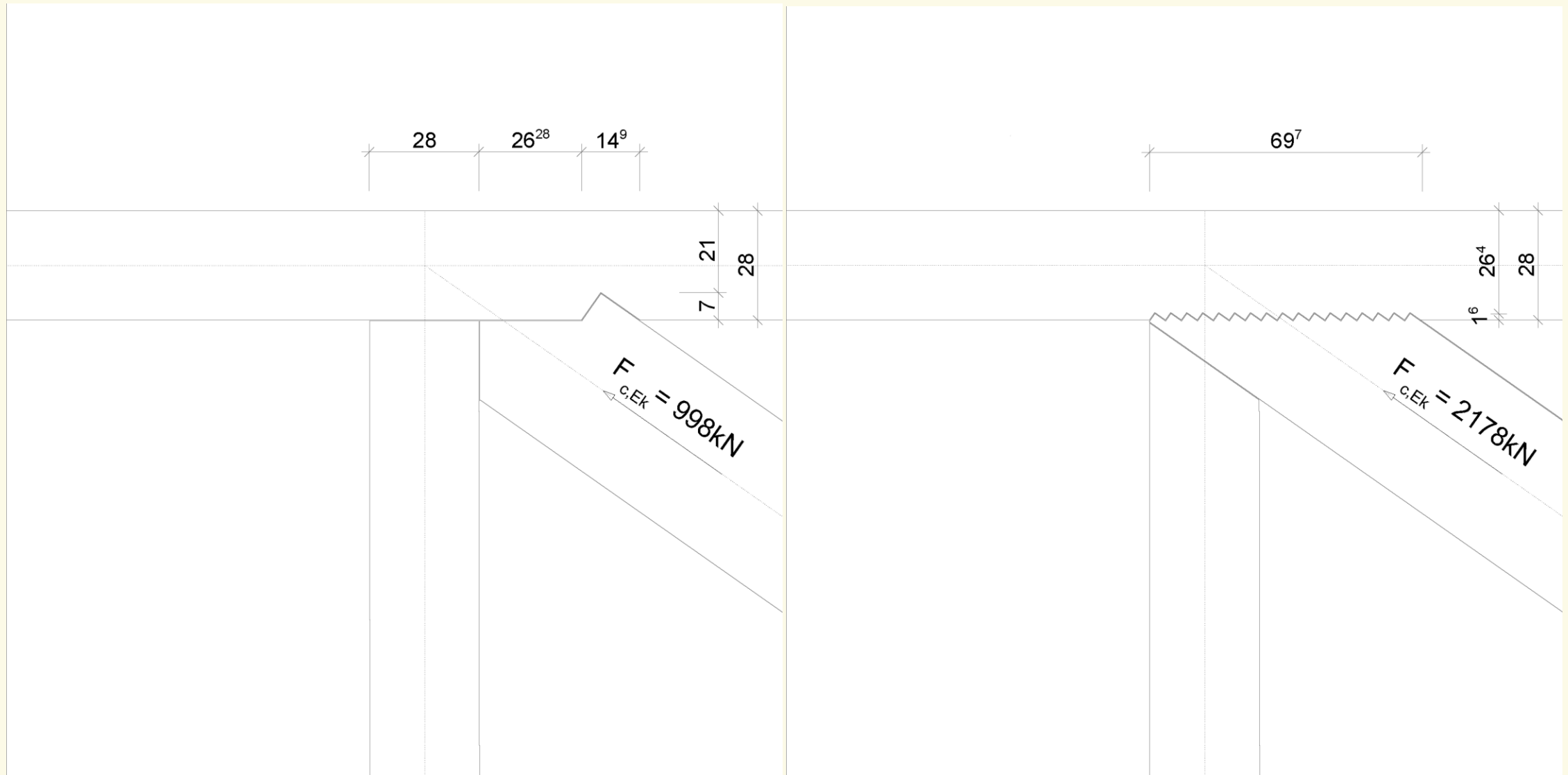

Baden-Württemberg

MINISTERIUM FÜR LÄNDLICHEN RAUM UND VERBRAUCHERSCHUTZ

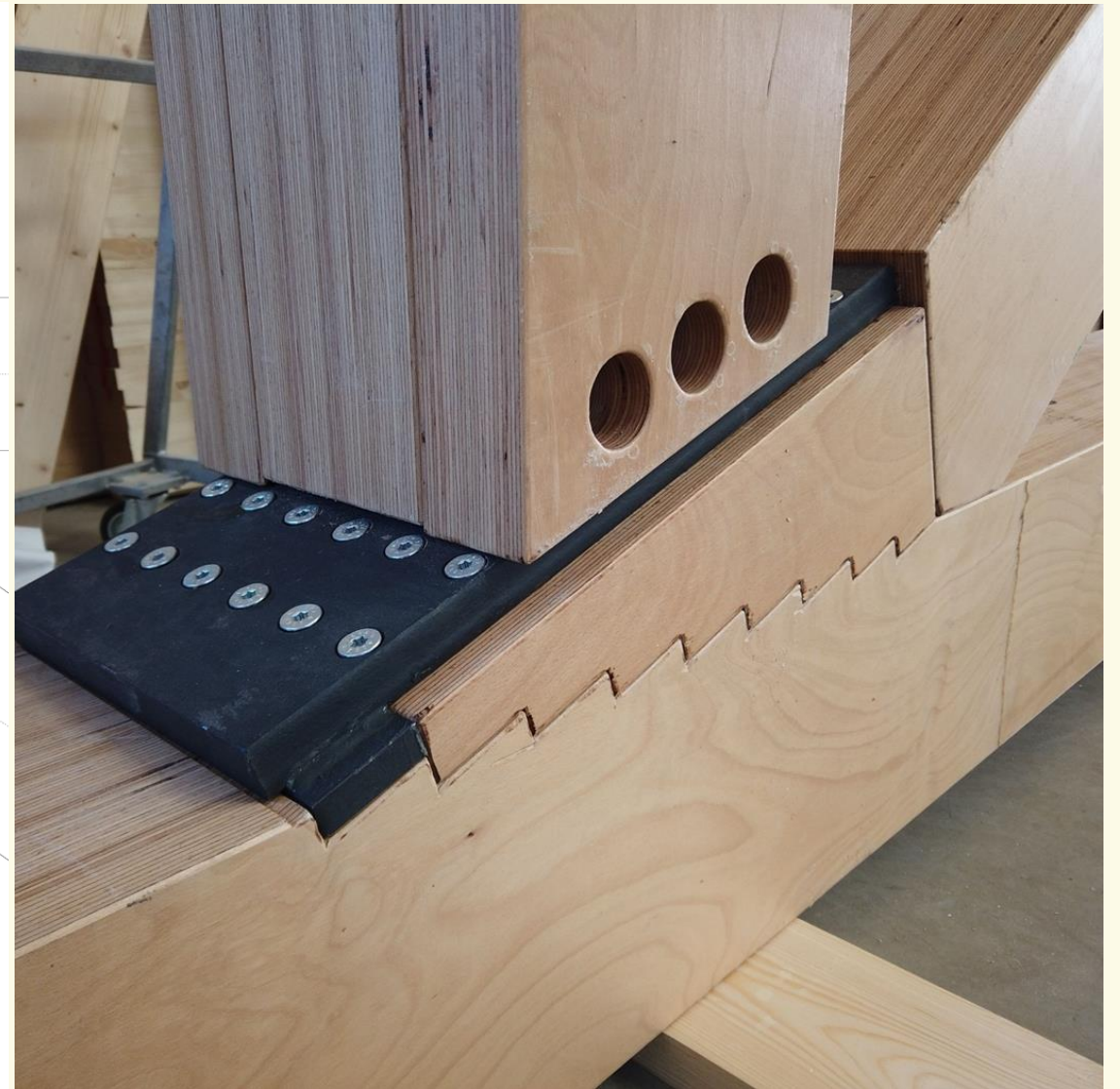
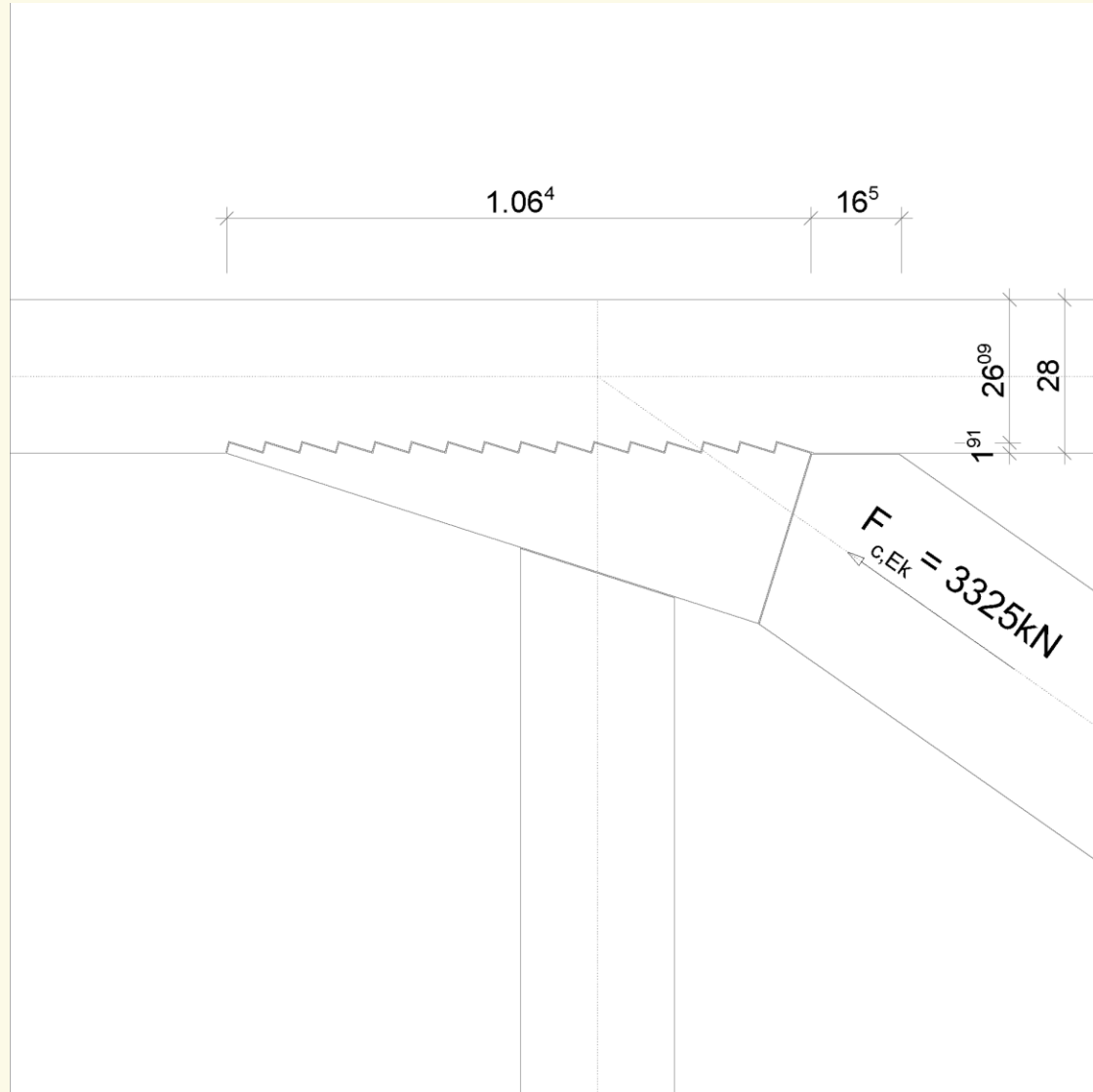

Baden-Württemberg

MINISTERIUM FÜR LÄNDLICHEN RAUM UND VERBRAUCHERSCHUTZ

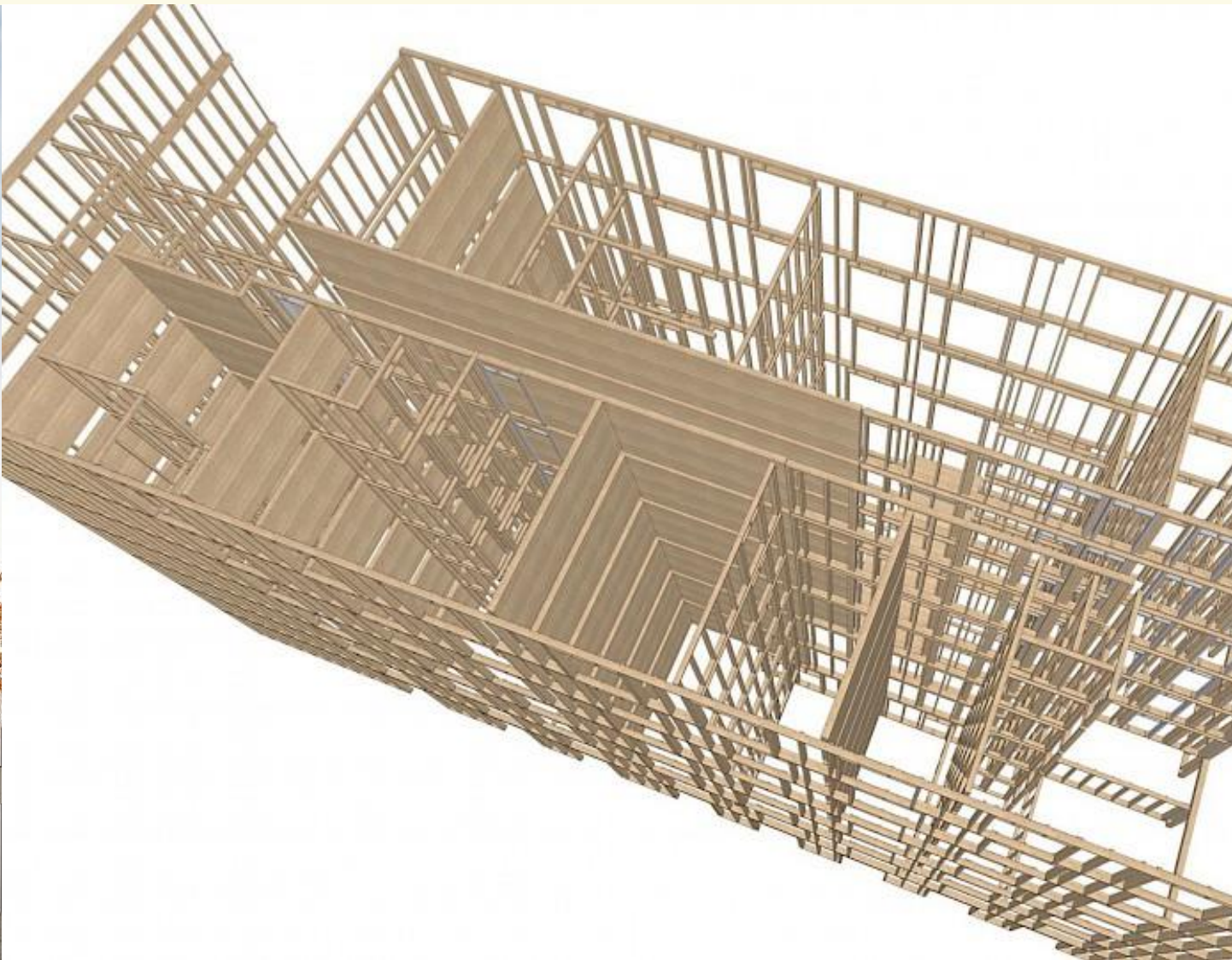

Baden-Württemberg

MINISTERIUM FÜR LÄNDLICHEN RAUM UND VERBRAUCHERSCHUTZ



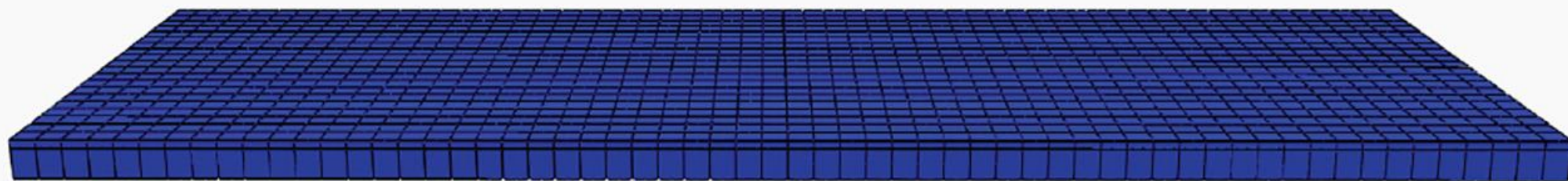

22 % WMC

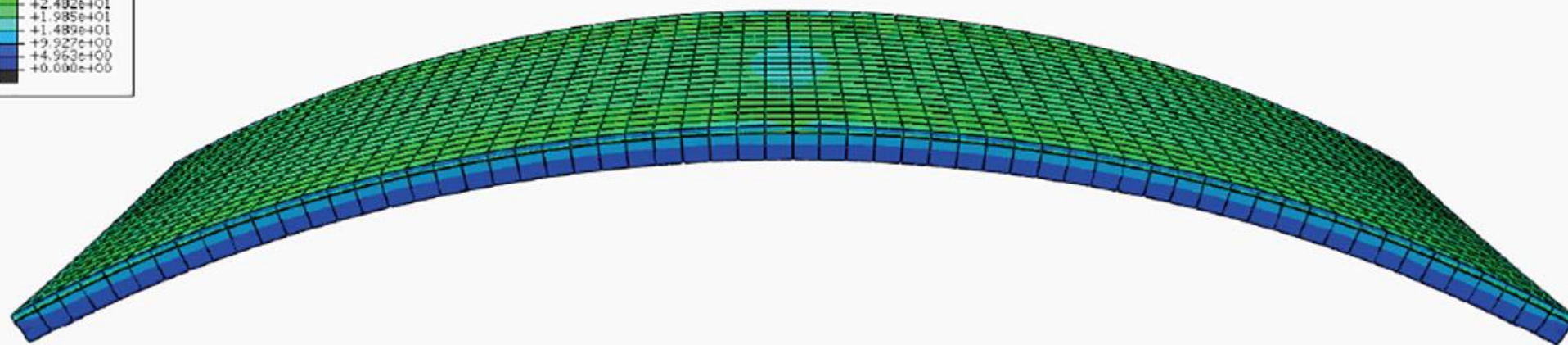
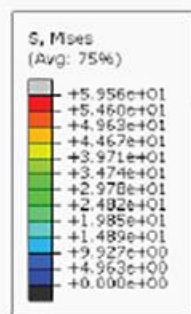

12 % WMC





22 % WMC



12 % WMC

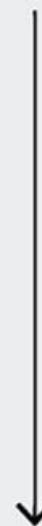

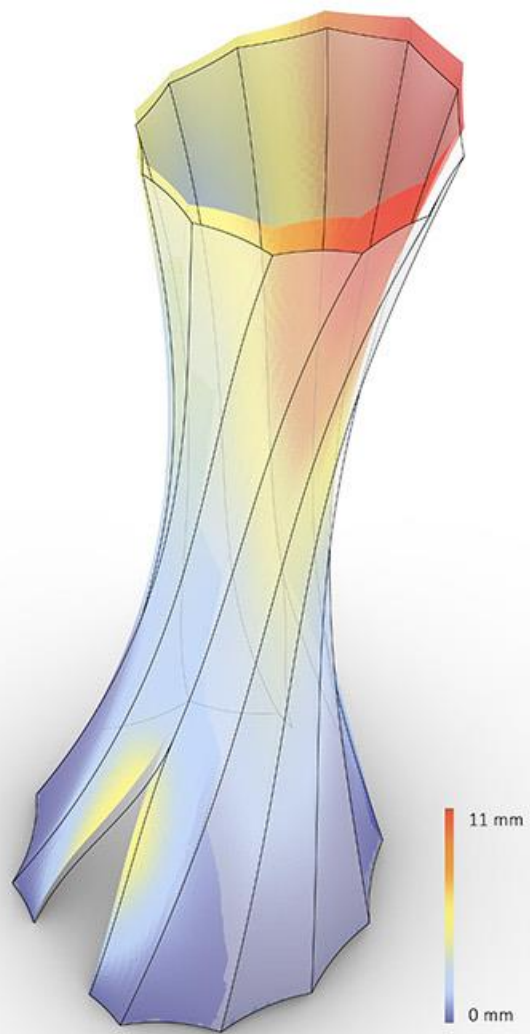

DEFORMATIONS

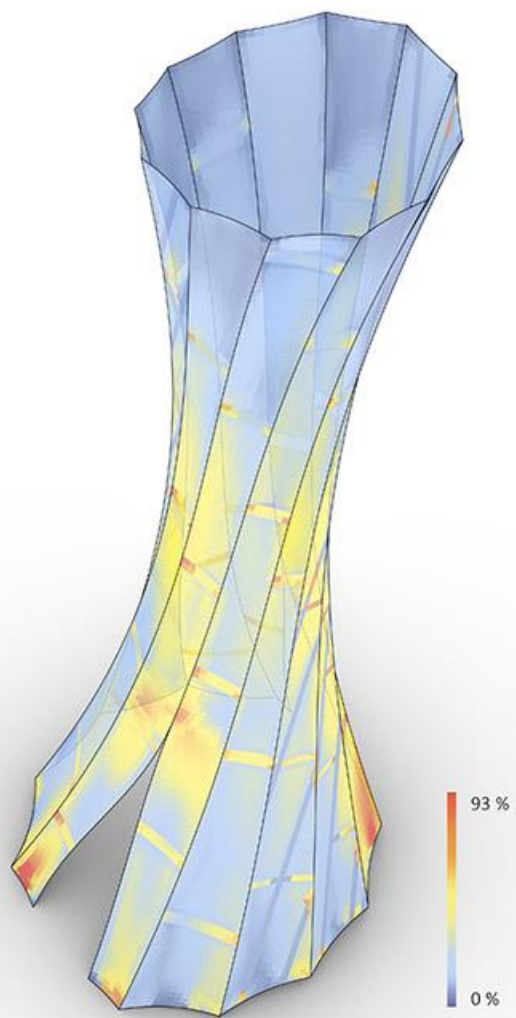

CLT UTILISATION

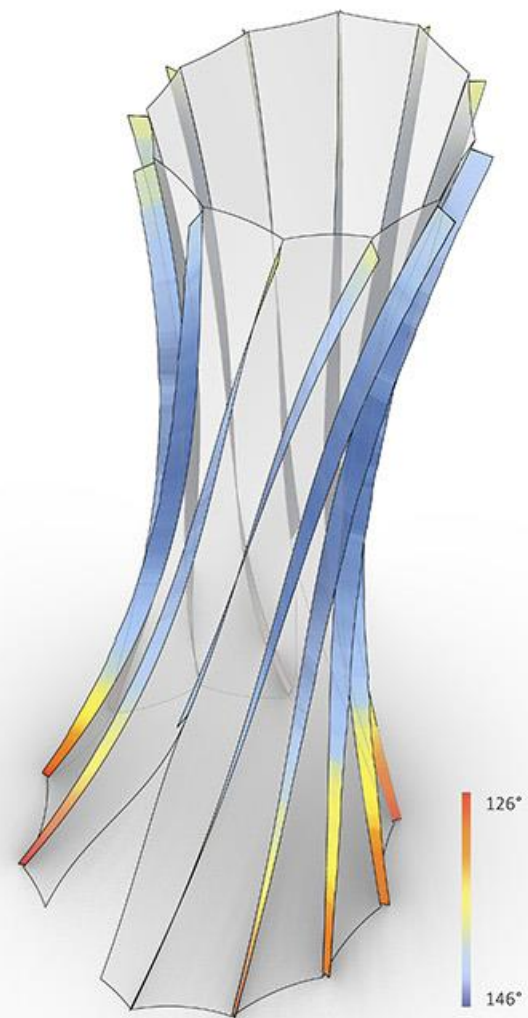

CONNECTION ANGLES











Endfolie

*“The way we build in the future,  
will decide our planets fate.”*

(Climate scientist Hans Joachim Schellnhuber, former Director of the PIK - Potsdam Institute for Climate Impact Research)

30% of the global energy and 40% of the global resources are currently consumed  
by the building sector!

WE HAVE A LOT TO DO!



Baden-Württemberg

MINISTERIUM FÜR LÄNDLICHEN RAUM UND VERBRAUCHERSCHUTZ



 Thank you for your attention!

[jan.bulmer@mlr.bwl.de](mailto:jan.bulmer@mlr.bwl.de) | +49 711 123 1054 | +49 172 253 44 26

